

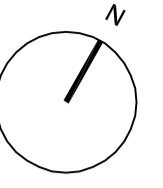

**NOTES:**

SUBJECT TO STATUTORY CONSENTS  
 SUBJECT TO SURVEY  
 BASED ON OS MAP REPRODUCED BY PERMISSION OF CONTROLLER OF HM STATIONARY OFFICE (c) CROWN COPYRIGHT  
 COPYRIGHT RESERVED  
 DO NOT SCALE THIS DRAWING  
 DO NOT USE ELECTRONIC VERSIONS OF THIS DRAWING TO DETERMINE DIMENSIONS UNLESS SPECIFICALLY AUTHORISED BY MICHAEL SPARKS ASSOCIATES  
 IF USING AN ELECTRONIC VERSION OF THIS DRAWING FIGURED DIMENSIONS TAKE PRECEDENCE AND NOTIFY MICHAEL SPARKS ASSOCIATES OF ANY DISCREPANCIES



ENSURE SEALING OF ALL JUNCTIONS TO COMPLY WITH PART L

U-Values	NOTE
Roof: 0.25	ROOF AND WALL CLADDING TO BE DESIGNED BY SPECIALIST CONTRACTOR
Floors: 0.25	CLADDING DETAILS TO BE READ IN CONJUNCTION WITH THE SPECIFICATION AND ALL RELEVANT BRITISH STANDARDS
Walls: 0.35	INCLUDE VAPOUR BARRIER TAPE AROUND ALL OPENINGS AND JUNCTIONS
Glazing: 1.50	

ALL DIMENSIONS TO BE CHECKED ON SITE.  
 STEEL COLUMN SIZES TO BE CONFIRMED AND TOLERANCES TO BE AGREED.

**CEILING FINISH NOTES**

- SUSPENDED CEILINGS WILL BE PROVIDED AS FOLLOWS:-
1. GENERALLY THROUGHOUT THE OFFICES AND ANCILLARY AREAS, ARMSTRONG PRIMA DUNE SUPREME 600 X 600MM TEGULAR TILES IN LAY-IN GRID SYSTEM WITH A STOVE ENAMELLED FINISH ON WIRE HANGERS.
  2. TOILETS WILL HAVE ARMSTRONG PRIMA DUNE SUPREME 600 X 600 TILES IN LAY-IN GRID SYSTEM.
  3. A SHADOWLINE PERIMETER TRIMS WILL BE INCLUDED TO ALL OFFICE AREAS. THE SUSPENDED CEILING SYSTEM IS TO BE EARTH BONDED IN ACCORDANCE WITH I.E.E. REGULATIONS AND THE SUSPENDED CEILING MANUFACTURERS RECOMMENDATIONS.

**NB.**  
 LAYOUT SHOWN IS INDICATIVE. SUBCONTRACTOR TO CONFIRM OPTIMUM SETTING OUT POINT TO SITE DIMENSIONS FOR ARCHITECTS APPROVAL/COMMENTS.

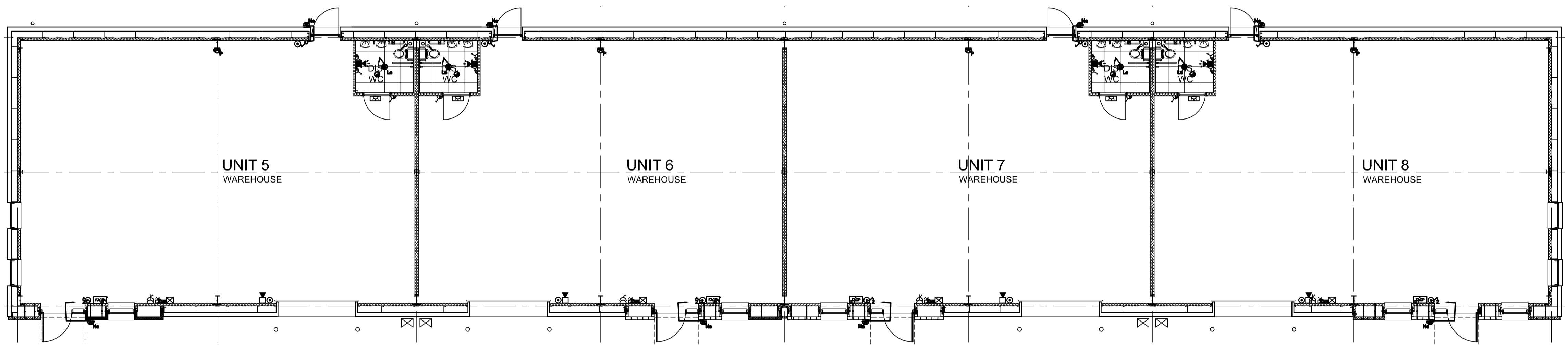

01 UNITS 5-8 - CEILING PLAN, GF  
 1207 1:100

# AS BUILT

THIS "AS-BUILT" DRAWING IS BASED ON INFORMATION SUPPLIED TO MICHAEL SPARKS ASSOCIATES BY MC LAREN CONSTRUCTION AND INCORPORATES INSTRUCTIONS AND OTHER DESIGN INFORMATION GIVEN TO MC LAREN CONSTRUCTION DIRECTLY BY OTHERS

A	25.03.2009	Refer to sub-contractors drawings for specialist details This supercedes drawing no: 2716/RE/273 rev.B	JH	NSC
REV	DATE	NOTE	DRAW	CHK

**MICHAEL SPARKS ASSOCIATES**  
 CHARTERED ARCHITECTS  
 11 PLATO PLACE  
 ST. DIONIS ROAD  
 LONDON SW6 4TU  
 TELEPHONE 020 7736 6162  
 FAX 020 7736 3896  
 www.msp-sparks.co.uk

**FROGMORE**

**KEY**

- AC CASSETTE
- 600mmx600mm GRILLE
- CIRCULAR GRILLE
- 600x600mm FLUORESCENT LUMINAIRE
- RECESSED DOWNLIGHTER
- PRESENCE + DAYLIGHT SENSOR
- OPTICAL SMOKE DETECTOR

ALL CEILING FITTINGS AS PER M&E SUBCONTRACTOR'S DESIGN

FOR FURTHER INFORMATION REFER TO THE RESPECTIVE M&E SUBCONTRACTOR'S DRAWING

TITLE  
**CROSSWAYS, DARTFORD**

DRAWING  
**SCHOONER PARK UNITS 5-8 REFLECTED CEILING PLANS**

CLIENT  
**FROGMORE**

DATE	SCALE	DRAWN
MARCH 2009	1:100 @ A1	JH
	STATUS	CHECKED
	AS BUILT	NSC
DRAWING NUMBER		
2716 / AB / 1207 A		

