

NOTES:
 SUBJECT TO STATUTORY CONSENTS
 SUBJECT TO SURVEY
 BASED ON OS MAP REPRODUCED BY PERMISSION OF CONTROLLER OF HM STATIONARY OFFICE (c) CROWN COPYRIGHT
 COPYRIGHT RESERVED
 DO NOT SCALE THIS DRAWING
 DO NOT USE ELECTRONIC VERSIONS OF THIS DRAWING TO DETERMINE DIMENSIONS UNLESS SPECIFICALLY AUTHORISED BY MICHAEL SPARKS ASSOCIATES
 IF USING AN ELECTRONIC VERSION OF THIS DRAWING FIGURED DIMENSIONS TAKE PRECEDENCE AND NOTIFY MICHAEL SPARKS ASSOCIATES OF ANY DISCREPANCIES
 BASED ON OS MAP REFERENCE NUMBER 10002048

KEY	
	RECTANGULAR 200x100MM BLOCK PAVING TO FOOTPATHS LAID IN 45° HERRIBONE PATTERN COLOUR: GREY
	TARMAC TO ACCESS ROAD AND CAR PARKING BAYS
	PAVING SLABS 450 x 450MM
	TACTILE PAVING COLOUR: BUFF TO CONTRAST WITH SURROUNDING FLOOR FINISHES
	WHITE LINING TO PARKING BAYS
	KEY CLAMP HANDRAIL TO TOP OF RETAINING WALL
	PEA SHINGLE GRAVEL STRIP 200MM WIDE
	REPTILE RELOCATION AREA WITHIN SITE BOUNDARY
	150MM CONCRETE EDGING
	DROPPED KERBS
	HB2 NORMAL KERBS
	TRANSITION KERB
	GAS METER BOX SEMI CONCEALED
	BIN STORE - REFER TO MSA DRG. 2716/CA/567 FOR DETAILS
	CONDENSER - REFER TO M&E SUBCONTRACTOR DRAWINGS FOR DETAILS
	CYCLE HUBS
	CYCLE SHELTER
	LIGHTING COLUMNS, SINGLE, TWIN LIGHTING

FOR ASSOCIATED PLAN REFER TO 2716/RE/211

01 SCHOONER PARK EXTERNAL WORKS PLAN
 1:200

- REPTILE FENCING
- RETAINING WALL GABION
- PUBLIC FOOTPATH

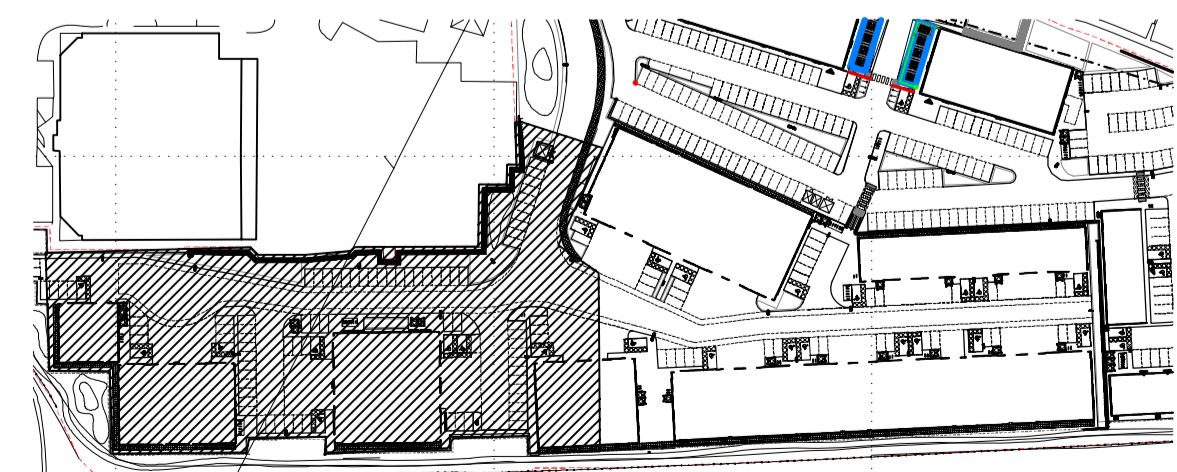

02 LOCATION PLAN
 1:2000

AS BUILT

THIS 'AS-BUILT' DRAWING IS BASED ON INFORMATION SUPPLIED TO MICHAEL SPARKS ASSOCIATES BY MC LAREN CONSTRUCTION AND INCORPORATES INSTRUCTIONS AND OTHER DESIGN INFORMATION GIVEN TO MC LAREN CONSTRUCTION DIRECTLY BY OTHERS

DATE	SCALE	DRAWN
MARCH 2009	1:200 @ A1	JS
STATUS	CHECKED	
AS BUILT	NSC	

DRAWING NUMBER: 2716 / AB / 1205 A

FROGMORE

CHARTERED ARCHITECTS
 11 PLATO PLACE
 STERLING ROAD
 LONDON SW8 4TU
 TELEPHONE: 020 7756 4162
 FAX: 020 7738 3896
 www.msa-architects.co.uk

TITLE: CROSSWAYS, DARTFORD
 DRAWING: SCHOONER PARK EXTERNAL WORKS
 CLIENT: FROGMORE